

Messeinsätze und Messtaster
Contact points

M 2.5

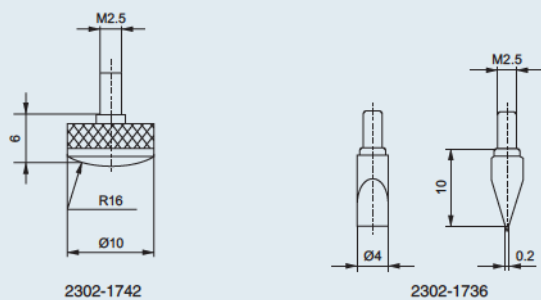
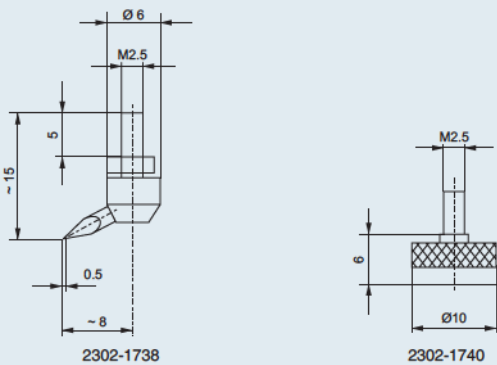
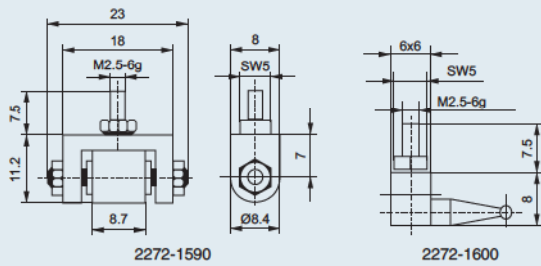
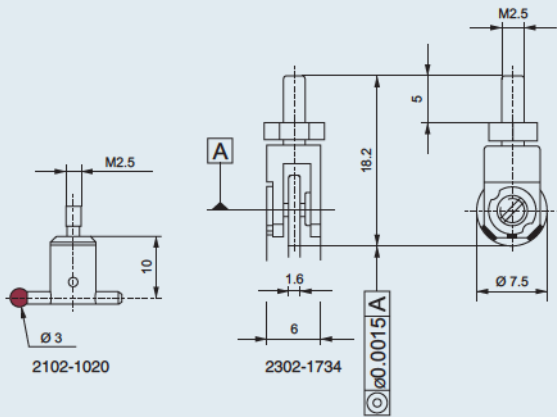

Bestell-Nr. Order no.	Bezeichnung Description
2102-1020	Messeinsatz Contact point
2302-1734	Messeinsatz gehärteter Stahl Contact point hardened steel
2272-1590	Messeinsatz Contact point
2272-1600	Messeinsatz Contact point
2302-1738	Messeinsatz gehärteter Stahl Contact point hardened steel
2302-1740	Messeinsatz gehärteter Stahl Contact point hardened steel
2302-1742	Messeinsatz gehärteter Stahl Contact point hardened steel
2302-1736	Messeinsatz gehärteter Stahl Contact point hardened steel

Messeinsätze und Messtaster Contact points

M 2.5

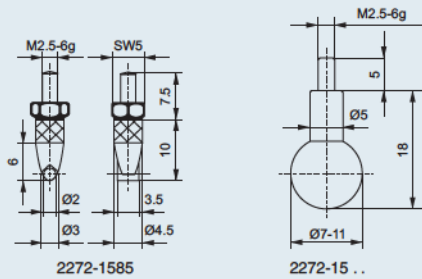

2272-1585

2272-15 ..

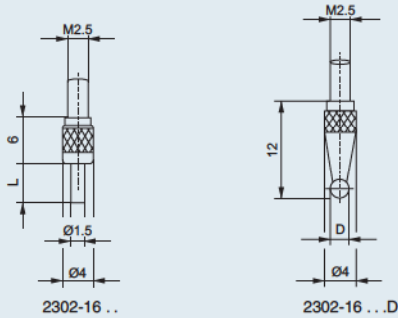

2302-16 ..

2302-16 ...D

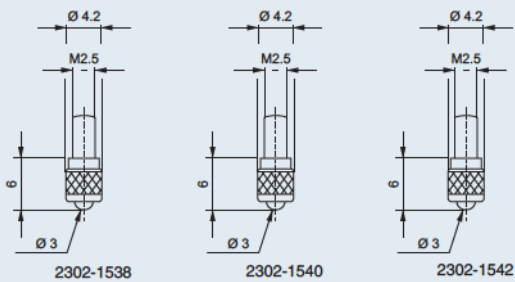

2302-1538

2302-1540

2302-1542

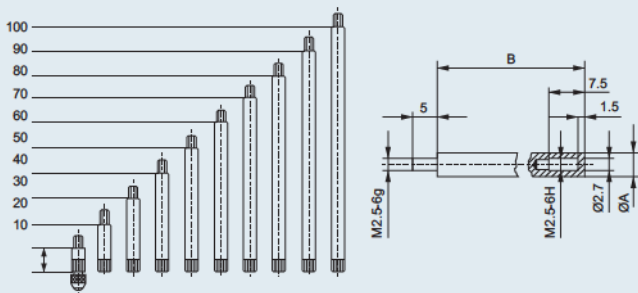

2302-17 ..

Bestell-Nr.
Order no.

Bezeichnung
Description

2272-1585

Messeinsatz
Contact point

2272-1510

Messeinsatz / Contact point

2272-1520

D= 7 mm

2272-1530

D= 8 mm

2272-1540

D= 9 mm

2272-1550

D= 10 mm

D= 11 mm

Messeinsatz Hartmetall

Contact point tungsten carbide

2302-1686

L= 5 mm

2302-1688

L= 10 mm

2302-1690

L= 15 mm

2302-1692

L= 20 mm

Messeinsatz Hartmetall

Contact point tungsten carbide

2302-1672

D= 1 mm

2302-1674

D= 2 mm

2302-1676

D= 3 mm

2302-1678

D= 4 mm

2302-1680

D= 5 mm

2302-1682

D= 6 mm

2302-1684

D= 6.35 mm

2302-1538

Messeinsatz gehärteter Stahl

Contact point hardened steel

2302-1540

Messeinsatz Hartmetall

Contact point tungsten carbide

2302-1542

Messeinsatz Rubin

Contact point Ruby

Verlängerung / Extension

2302-1714

L= 10 mm

2302-1716

L= 20 mm

2302-1718

L= 30 mm

2302-1720

L= 40 mm

2302-1722

L= 50 mm

2302-1724

L= 60 mm

2302-1726

L= 70 mm

2302-1728

L= 80 mm

2302-1730

L= 90 mm

2302-1732

L= 100 mm